

D.N.R. B.M. 1149 - A
 B.M. 'X' is a bronze tablet set in concrete post. 128' N. of public access, 133' E. of lake, 83' S. of triple trunked elm tree.
 Assumed elev. 100.00
 Water elev. 94.62

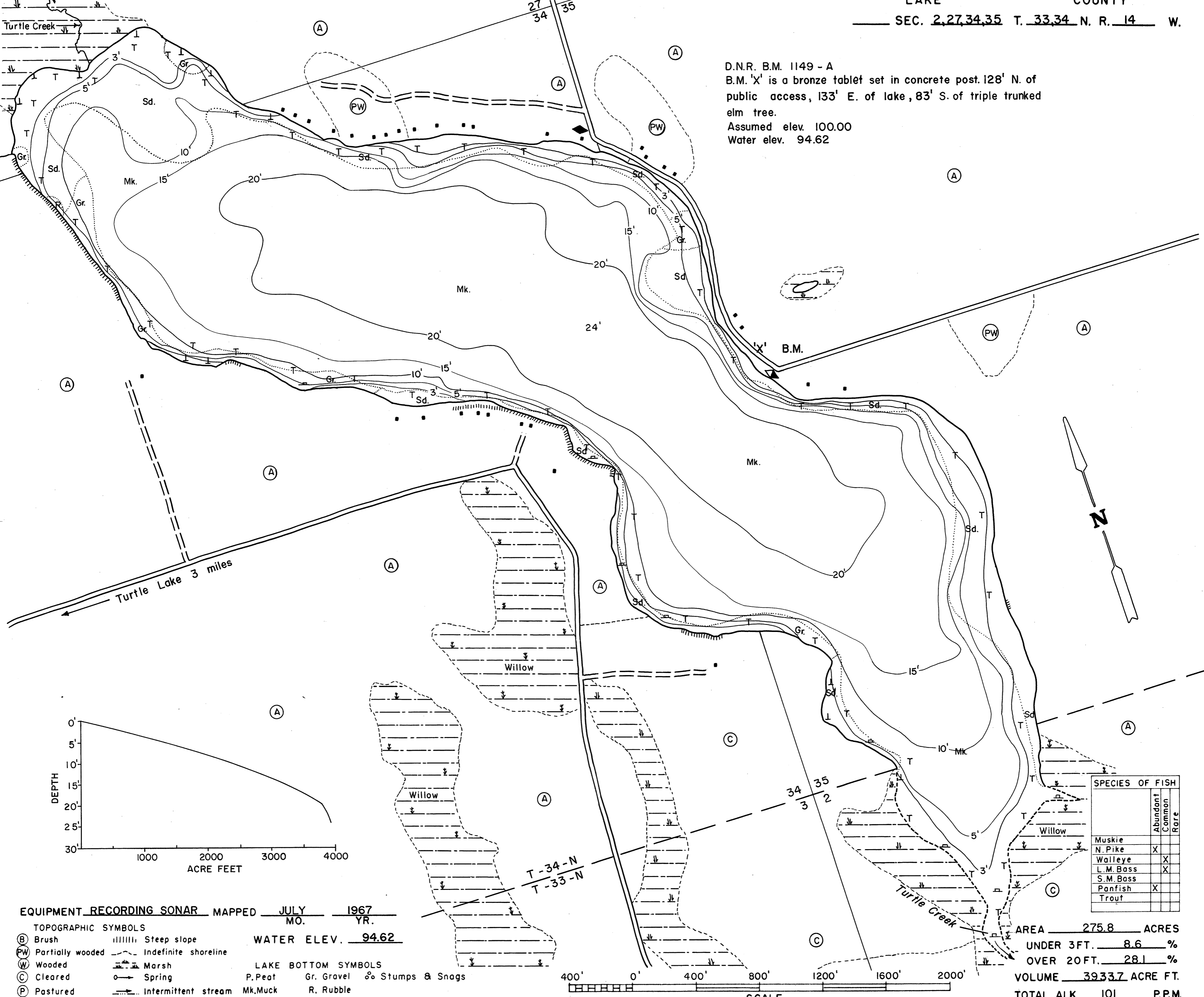

Turtle Lake 3 miles

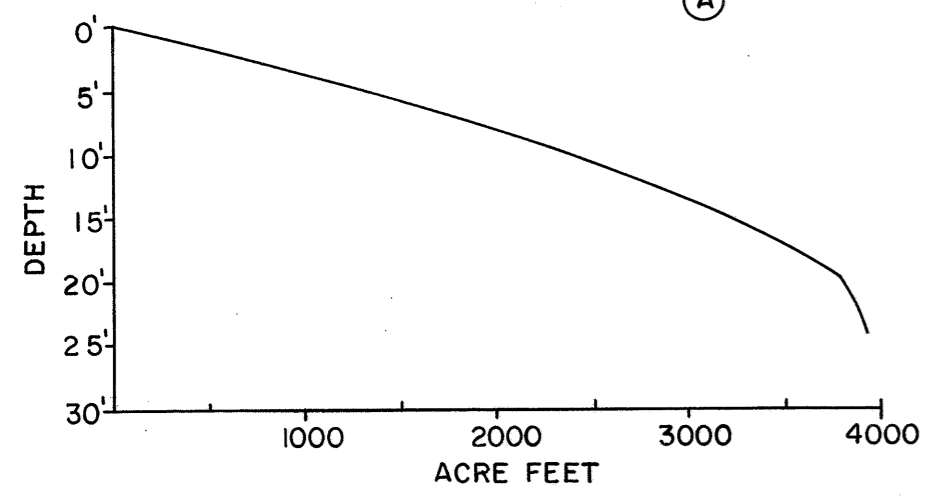

SPECIES OF FISH		
	Abundant	Rare
Muskie		
N. Pike	X	
Walleye		X
L. M. Bass		X
S. M. Bass		
Panfish	X	
Trout		

EQUIPMENT RECORDING SONAR MAPPED JULY 1967
 MO. YR.

- TOPOGRAPHIC SYMBOLS
- (B) Brush
 - (PW) Partially wooded
 - (W) Wooded
 - (C) Cleared
 - (P) Pastured
 - (A) Agricultural
 - B.M. Bench Mark
 - Dwelling
 - Resort
 - ||||| Steep slope
 - - - Indefinite shoreline
 - Marsh
 - o Spring
 - Intermittent stream
 - Permanent inlet
 - Permanent outlet
 - Dam

- LAKE BOTTOM SYMBOLS
- P. Peat
 - Mk. Muck
 - C. Clay
 - M. Marl
 - Sd. Sand
 - St. Silt
 - Gr. Gravel
 - R. Rubble
 - Br. Bedrock
 - T Submergent vegetation
 - ↓ Emergent vegetation
 - ⊕ Floating vegetation
 - ⊗ Stumps & Snags

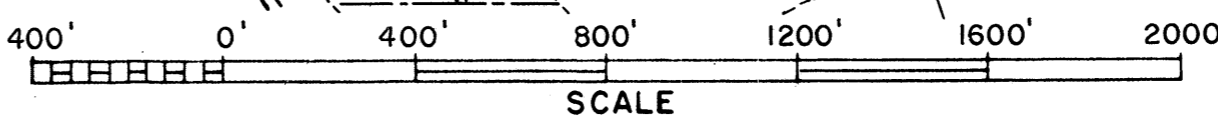

◇ Access ◆ Access with Parking ◆ Boat Livery
 Field work by C. Busch, G. Winter, L. Sather. Drawn by: C. Holt

AREA 275.8 ACRES
 UNDER 3FT. 8.6 %
 OVER 20FT. 28.1 %
 VOLUME 3933.7 ACRE FT.
 TOTAL ALK. 101 P.P.M.
 SHORELINE 3.8 MILES
 MAX. DEPTH 24 FEET

Source: Wisconsin Department of Natural Resources 608-266-2621
Lower Turtle Lake – Barron County, Wisconsin DNR Lake Map
Date – Jul 1967 - Historical Lake Map - Not for Navigation
A Public Document - Please Identify the Source when using it.